

Conference Programme

Wednesday, 7 November 2018

17:30 LuxERA Assembly (LuxERA members only), Room MSA 3.540

19:00 LuxERA Welcome Reception, Espace MSA 0352030, 3rd floor

17:00-19:30 Pre-Registration (name badges) for LuxERA Conference, Espace MSA 0352030

Thursday, 8 November 2018

9:00 Registration (Espace MSA 0352030, 3rd floor)

9:30 Conference opening – Welcome, Maison du Savoir, Room MSA 3.540

Claude Meisch, Minister of Education, Children and Youth, Luxembourg (t.b.c.)

Stéphane Pallage, Rector, University of Luxembourg

Georg Mein, Dean, Faculty of Language and Literature, Humanities, Arts and Educational Sciences (FLSHASE), University of Luxembourg

Andreas Hadjar, LuxERA president

10:00 Theo Wubbels, University of Utrecht (The Netherlands), former EERA president

Video note *Educational Research*

Lorenz Lassnigg (Institute of Advanced Studies Vienna/AT)

Keynote *Are we all exceptional? Structures of lifelong learning in comparative perspective*

Maison du Savoir, Room 3.540

Chair: Andreas Hadjar

10:50 Morning coffee break (Espace MSA 0352030, 3rd floor)

11:15 Parallel Sessions 1

Learning and Cognition I (EN)

Chair: Sonja Ugen

Maison du Savoir, Room MSA 4.150

Teacher Training and Professionalization I

(DE/LU/EN)

Chair: Ineke Pit-ten Cate

Maison du Savoir, Room MSA 4.190

Cíntia Ertel & Pascale Engel de Abreu
(Institute for Research on Multilingualism,
FLSHASE, UL/LU)

*The role of the first language in learning to
read in a second: An individual difference
study with Portuguese-speaking language
minority children in Luxembourg*

Ruth Arimond (Institut de formation de
l'Education nationale, IFEN/LU)

*Professionelle Wahrnehmung im
Klassenraum. Förderung der
Reflexionskompetenz durch eine fokussierte
Beobachtungsaufgabe und Social Video
Learning in der Lehrer/innenausbildung*

Carrie Georges (Institute for Cognitive Science and Assessment, FLSHASE, UL/LU)
The relation between visuospatial abilities and verbal number skills in preschool: Adding spatial language to the equation

Claudine Kirsch, Katja Andersen (Institute for Research on Multilingualism, FLSHASE, UL/LU) & Gabriela Aleksić (Institute of Health and Behaviour, FLSHASE, UL/LU)
The influence of a professional development on teachers' and carers' multilingual practices in early childhood education in Luxembourg

Aliette Lochy (Institute for Cognitive Science and Assessment, FLSHASE, UL/LU), Alice van de Walle de Ghelcke (Université Catholique de Louvain/BE), Bruno Rossion (Université de Lorraine/FR) & Christine Schiltz (Institute for Cognitive Science and Assessment, FLSHASE, UL/LU)
The global method of learning to read induces an atypical brain activation in beginning readers

Tessa E. Lehnert (Institute of Health and Behaviour, FLSHASE, UL/LU)
Der Einfluss von expliziten und impliziten Einstellungen gegenüber Sprache und Nationalität auf die Personenwahrnehmung in mehrsprachigen Kontexten

Alexandre Poncin, Amadine Van Rinsfeld & Christine Schiltz (Institute for Cognitive Science and Assessment, FLSHASE, UL/LU)
Two-digit number transcoding in bilingual and monolingual adults

Pascale Engel de Abreu, Carolina Nikaedo, Ariana Loff, Rute Tomás (Institute for Research on Multilingualism, FLSHASE, UL/LU), Veronique Cornu, Romain Martin (Luxembourg Centre for Educational Testing, FLSHASE, UL/LU), Silke Fricke (University of Sheffield/UK), Charles Hulme & Maggie Snowling (University of Oxford/UK)
Multilinguaalt Léierpotenzial fërderen. Eng randomiséiert kontrolléiert Studie mat Kanner zu Lëtzebuerg, di doheem Portugisesch schwätzen

13:00 Lunch Break

14:00 Parallel Sessions 2

Social Aspects (DE/EN)
Chair: Justin Powell
Maison du Savoir, Room MSA 4.150

Learning settings I (DE/LU/FR)
Chair: Claudine Kirsch
Maison du Savoir, Room MSA 4.190

Monique Reichert, Charlotte Kramer, Salvador Rivas, Rachel Wollschläger & Sonja Ugen (Luxembourg Centre for Educational Testing, FLSHASE, UL/LU)
Sozio-ökonomischer Status, Sprachhintergrund und außerschulische Lesegewohnheiten: Wie gut erklären diese Variablen die Lesekompetenz der Jugendlichen?

Nancy Morys (Institute for Research on Multilingualism, FLSHASE, UL/LU)
Französischunterricht im spezifischen Bildungskontext Luxemburgs - Ressourcen, Herausforderungen und Perspektiven für die Unterrichtsentwicklung

Kevin Simoes Loureiro & Andreas Hadjar
(Institute of Education and Society,
FLSHASE, UL/LU)

*Educational inequalities in Luxembourg: The
role of students' language backgrounds in
school grades*

Jessica Levy (Luxembourg Centre for
Educational Testing, FLSHASE, UL/LU),
Martin Brunner (Department
Erziehungswissenschaft, Universität
Potsdam/DE), Ulrich Keller & Antoine
Fischbach (Luxembourg Centre for
Educational Testing, FLSHASE, UL/LU)
*Wat droen d' Schoulen zur Leeschtung vu
Schülerinnen a Schüler bai? E
systemateschen Iwwerbléck iwwer déi
aktuell Fuerschungslag an Uwendung u
lëtzebuergesche Längsschnëtt-Donnéeën*

Sabrina Göbel (Institute for Research and
Innovation in Social Work, Social Pedagogy
and Social Welfare, FLSHASE, UL/LU)
*Exemplarische Bildungsverläufe von
Jugendlichen in den Erziehungshilfen und im
Übergang*

Christian Meyers (Institute for Applied
Educational Sciences, FLSHASE, UL/LU)
*Le Grand-Duché de Luxembourg comme
nouvelle "terre promise des start up et
creative hubs": Et le système scolaire
luxembourgeois dans tout ça?*

Alyssa Grecu & Andreas Hadjar (Institute of
Education and Society, FLSHASE, UL/LU)
*Klassenklima und Schulentfremdung in
luxemburgischen Grundschulen. Die
Bedeutung von Lehrstil und Lehrer/innen-
Schüler/innen-Beziehungen: Eine Mixed-
Method-Studie*

Florian Klapproth (Berlin Medical
School/DE), Antoine Fischbach, Ulrich Keller
& Sonja Ugen (Luxembourg Centre for
Educational Testing, FLSHASE, UL/LU)
*Wie wirken sich Klassenwiederholungen in
der Sekundarstufe 1 auf spätere Schulnoten
aus. Eine Längsschnittstudie*

15:45 Afternoon coffee break (Espace MSA 0352030, 3rd floor)

16:15 Round Table Discussion *Researching Education in Luxembourg*
Maison du Savoir, Room MSA 3.540

Chair: Antoine Fischbach, Luxembourg Educational Research Association/LU

Guests:

Claude Adam, University of Luxembourg/LU

Erna Hennicot-Schoepges, former Member of the European Parliament/LU

Sabine Glock, School of Education, University of Wuppertal/DE

Jens Kreisel, Vice Rector Research, University of Luxembourg/LU

Christian Lamy, Directeur Adjoint, Service de Coordination de la Recherche et de l'Innovation
pédagogiques et technologiques, SCRIPT/LU

17:15 Interval

17:30 Poster Session, Book Fair & Aperó, Maison du Savoir, Espace MSA 0352030

Posters

- Aigul Alieva (Luxembourg Institute for Socio-economic Research, LISER/LU) & Vincent Hildebrand (Department of Economics, University of York/CA): *Persisting ethnic inequalities in education in Luxembourg*
- Flavia Bley (Institute for Research on Multilingualism, FLSHASE, UL/LU): *How parents, teachers and caretakers provide (multi)languages learning opportunities for 3 newly-arrived Brazilian children in Luxembourg - a sociocultural approach*
- Joanne Colling & Pascale Engel de Abreu (Institute for Research on Multilingualism, FLSHASE, UL/LU): *How multilinguals are learning to read and write in a second language in Luxembourg. The relationship between oral language and reading in the first year of primary school*
- Max Greisen (Institute for Cognitive Science and Assessment, FLSHASE, UL/LU), Caroline Hornung, Romain Martin (Luxembourg Centre for Educational Testing, FLSHASE, UL/LU) & Christine Schiltz (Institute for Cognitive Science and Assessment, FLSHASE, UL/LU): *Assessing basic number competence without language instruction: Pilot studies*
- Danielle Hoffmann, Caroline Hornung, Sylvie Gamo, Pascale Esch, Ulrich Keller & Antoine Fischbach (Luxembourg Centre for Educational Testing, FLSHASE, UL/LU): *Schulische Kompetenzen von Erstklässlern und ihre Entwicklung nach zwei Jahren: Erste längsschnittliche Befunde aus dem nationalen Bildungsmonitoring*
- Christian Meyers (Institute for Applied Educational Sciences, FLSHASE, UL/LU): *Reflexions et pistes sur le nouveau cours "Vie et société" de l'enseignement fondamental au Luxembourg. Est-ce que tout était vraiment mieux avant?*
- Claire Muller, Yanica Reichel, Rachel Wollschläger, Philipp Sonnleitner & Antoine Fischbach (Luxembourg Centre for Educational Testing, FLSHASE, UL/LU): *Cognitive potential and academic success in Luxembourg: Use case of the "Test of Cognitive Potential"*
- Melanie Noesen (Institute for Research on Multilingualism, FLSHASE, UL/LU): *Sprachliche Lern- und Handlungsräume in der Portfolioarbeit*
- Christina Siry & Sara E.D. Wilmes (Institute for Applied Educational Sciences, FLSHASE, UL/LU): *Student science notebook use in a Luxembourg Primary Classroom: the dance of the individual I collective*

Books

- Backes, Susanne (2018). Heterogenität im Luxemburgischen Schulsystem. Weinheim: BeltzJuventa.
- Dusdal, Jennifer (2018): *Welche Organisationsformen produzieren Wissenschaft?* Frankfurt am Main: Campus.
- Gardin, Matias & Thomas Lenz (Eds.) (2018). Die Schule der Nation. Weinheim: BeltzJuventa.
- Hadjar, Andreas & Christiane Gross (Eds.) (2016). *Education Systems and Inequalities*. Bristol: Policy Press.
- Krolak-Schwerdt, Sabine, Ineke M. Pit-ten Cate & Thomas Hörstermann (2018). Teachers' judgments and decision making: Studies concerning the transition from primary to secondary education and their implications for teacher education. In: Olga Zlatkin-Troitschanskaia, Miriam Toepper, Hans Anand Pant, Corinna Lautenbach & Christiane Kuhn (Eds). *Assessment of Learning Outcomes in Higher Education*. Dordrecht, the Netherlands: Springer

Ministère de l'Éducation nationale, de l'Enfance et de la Jeunesse, Service des Statistiques et Analyses & Université du Luxembourg, FLSHASE (Faculté des Lettres, des Sciences humaines, des Arts et des Sciences de l'Éducation) (Eds.) (2015). *Bildungsbericht Luxemburg 2015*. Luxembourg: MENJE/Service des Statistiques et Analyses/Université du Luxembourg.

Ministerium für Bildung, Kinder und Jugend, SCRIPT (Service de Coordination de la Recherche et de l'Innovation pédagogiques et technologiques) & Universität Luxemburg, LUCET (Luxembourg Centre for Educational Testing) (Eds.) (2016).

PISA 2015. Nationaler Bericht Luxemburg. Luxembourg: SCRIPT/LUCET.

Zapp, Mike, Marcelo Marques & Justin Powell (2018). *European Educational Research (Re)Constructed*. Oxford: Symposium Books.

19:00 Interval

19:30 Conference dinner (Dimmi Si)

Friday, 9 November 2018

9:00 Parallel Sessions 3

Learning settings II (EN)

Chair: Béatrice Arend

Maison du Savoir, Room MSA 4.520

Sarah Degano (Institute for Research on Multilingualism, FLSHASE, UL/LU)
(Dis)engaging in German, Mathematics and Sciences classes. How do Primary School Children in Multilingual Luxembourg Communicate with each Other?

Anna M. Gorges, Christina Siry (Institute for Applied Educational Sciences, FLSHASE, UL/LU) & Melanie Noesen (Institute for Research on Multilingualism, FLSHASE, UL/LU)

Developing a 'successful student' identity: The case of a multilingual student at an alternative secondary school

Inclusive Education (EN/LU)

Chair: Jennifer Dusdal

Maison du Savoir, Room MSA 4.160

Ineke Pit-ten Cate & Mireille Krischler (Institute for Cognitive Science and Assessment, FLSHASE, UL/LU)
Teachers' attitudes toward the inclusion of students with special educational needs in Luxembourg: Associations with training and perceived competence

Justin Powell (Institute of Education and Society, FLSHASE, UL/LU)
Die Notwendigkeit inklusiver Bildung für die Erneuerung der Governance-Konzepte: Deutschland und Luxemburg im Vergleich

Lindie van Westhuizen, Irma Talic, Samuel Greiff (Institute for Cognitive Science and Assessment, FLSHASE, UL/LU), Antoine Fischbach (Luxembourg Centre for Educational Testing, FLSHASE, UL/LU) & Christoph Niepel (Institute for Cognitive Science and Assessment, FLSHASE, UL/LU)
Dimensional and Social Comparison Effects on Domain-Specific Self-Concepts and Interests: A Study of Elementary School Children from Luxembourg Across Two Waves

Michelle Brendel (Institute for Applied Educational Sciences, FLSHASE, UL/LU) & Justin Powell (Institute of Education and Society, FLSHASE, UL/LU)
Film "Inklusioun. Zesumme liewen, zesumme léieren", Ecole Jean Jaurès (MENJE & UL;TdiverS Project)

10:20 Morning coffee break (Espace MSA 0352030, 3rd floor)

10:50 Parallel Sessions 4

Learning and Cognition II (EN)

Chair: Ineke Pit-ten Cate

Maison du Savoir, Room MSA 4.520

Sophie Martini & Sonja Ugen (Luxembourg Centre for Educational Testing, FLSHASE, UL/LU)

Language Choice and Achievement on a Bilingual Math Test in German-French biliterate ninth-graders in Luxembourg

Patrick Franzen, Lindie van der Westhuizen, Samuel Greiff (Institute for Cognitive Science and Assessment, FLSHASE, UL/LU), Antoine Fischbach (Luxembourg Centre for Educational Testing, FLSHASE, UL/LU) & Christoph Niepel (Institute for Cognitive Science and Assessment, FLSHASE, UL/LU)
Developing and validating a short-form questionnaire for the assessment of seven conscientiousness facets in educational large-scale assessments

Irma Talic, Patrick Franzen, Samuel Greiff & Christoph Niepel (Institute for Cognitive Science and Assessment, FLSHASE, UL/LU)
Replicating and Extending the GI/E Model: Social and Dimensional Comparison Effects of Achievement on Test Anxiety in Math, Physics, German and English

Learning settings III (EN)

Chair: Ariane König

Maison du Savoir, Room MSA 4.160

Constanze Weth (Institute for Research on Multilingualism, University of Luxembourg/LU), Natalia Bilici, Linda Brucher & Sonja Ugen (Luxembourg Centre for Educational Testing, FLSHASE, UL/LU)
Training and assessing spelling skills related to German syntactic markers in Luxembourg

Sarah Muller (Center for Luxembourg Studies, University of Sheffield/UK)
Language Education Policy in Luxembourg: Perspectives of Primary School Students

Simone Mortini (Institute for Research on Multilingualism, FLSHASE, UL/LU)
Children's languaging and peer interaction in non-formal early childhood education in Luxembourg

12:10 Sandwich Lunch, Maison du Savoir, Room MSA 4.520

Theo Wubbels, University of Utrecht (The Netherlands), former EERA president
Lunchtime Keynote (video presentation) *Effective (higher) education: theory and practice*

Chair: Justin Powell

13:15 Parallel Sessions 5

Education and Science Systems (EN)

Chair: Andreas Hadjar

Maison du Savoir, Room MSA 4.520

Jennifer Dusdal (Institute of Education and Society, FLSHASE, UL/LU)

Rising scientific productivity and internationalization in Luxembourg's higher education and science system in comparison to Germany, France and Belgium

Lukas Graf (Hertie School of Governance, Berlin/DE) & Matias Gardin (Chungdahm Institute/CDI, South Korea)

Transnational skills development in post-industrial knowledge economies: the case of Luxembourg and the Greater Region

Mike Zapp, Marcelo Marques & Justin Powell (Institute of Education and Society, FLSHASE, UL/LU)

Comparing Institutional Change in Educational Research Governance in Germany, the UK, Norway and the EU

Teacher Training & Professionalization II (EN)

Chair: Antoine Fischbach

Maison du Savoir, Room MSA 4.160

Tanja Gabriele Baudson (Institute for Cognitive Science and Assessment, FLSHASE, UL/LU)

Do Teachers Weigh Social and Intellectual Abilities Against Each Other When Rating Students of Different IQ Levels?

Christina Siry, Kerstin te Heesen, Sara E.D. Wilmes, Sandy Heinericy & Nora Kneip (Institute for Applied Educational Sciences, FLSHASE, UL/LU)

Enacting Relational Agency in the Development of Sustainable Science Teacher Professional Development Network in Luxembourg

Philipp Sonnleitner, Charlotte Krämer, Sylvie Gamo, Monique Reichert, Claire Muller, Ulrich Keller & Sonja Ugen (Luxembourg Centre for Educational Testing, FLSHASE, UL/LU)

Schülerkompetenzen im Längsschnitt: Die Entwicklung von Deutsch-Leseverstehen und Mathematik in Luxemburg zwischen der 3. und 9. Klasse

14:35 Interval

14:45 Conference Farewell

Location map

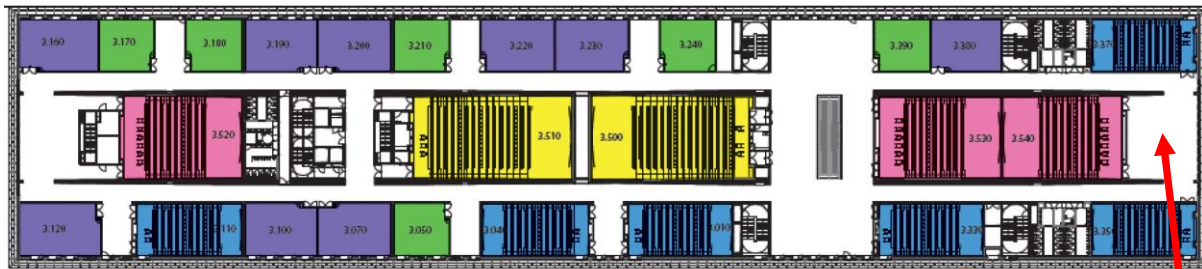

Maison du Savoir - 3^{ème} étage

Espace MSA
0352030 (coffee
breaks, poster
session)

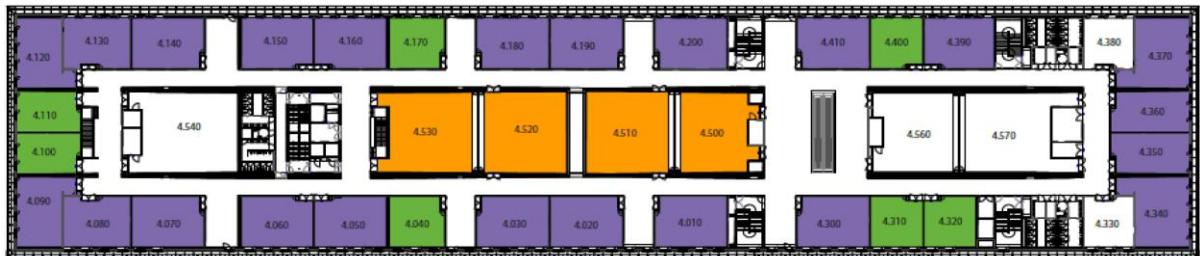

Maison du Savoir - 4^{ème} étage

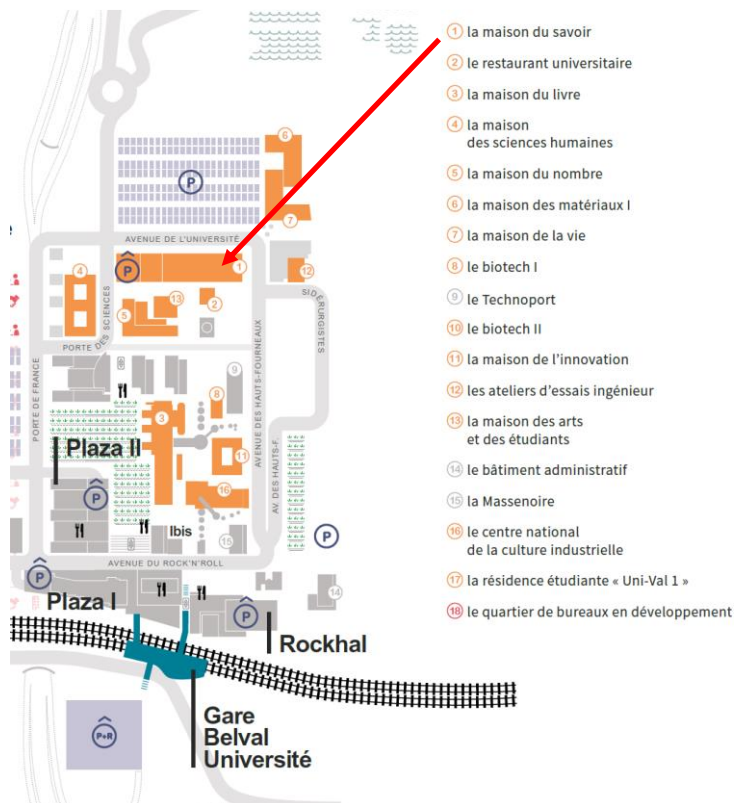

A conference organised by



Candidate member of



Research for the benefit of education and society

Conference hosted by



The conference is supported by additional funds provided by

Faculty of Language and Literature, Humanities, Arts and Educational Sciences,
University of Luxembourg

Research Unit Education, Culture, Cognition and Society (ECCS), University of Luxembourg

Luxembourg Centre for Educational Testing, FLSHASE, University of Luxembourg

Institute of Education and Society (InES), FLSHASE, ECCS, University of Luxembourg

Organising Committee:

Antoine Fischbach • Andreas Hadjar • Ineke Pit-ten Cate • Justin Powell • Sonja Ugen

Contact: LuxERA, Maison des Sciences Humaines,

11, Porte des Sciences, L-4366 Esch-sur-Alzette, Luxembourg, eMail: luxera@uni.lu

Become a member of the Luxembourg Educational Research Association (LuxERA)

Check out our website www.luxera.lu for further information and the membership form.